

Heavy-duty, full face Wafer Type & Lug Type Butterfly valves for On/Off service, or for controlling the flow of water or chemicals. The gear operator with position indicator provides excellent throttling capability and ease of operation.

FEATURES AND BENEFITS

- Full boot-seal for durable performance
(No flange gaskets required)
- 100% bubble tight shut-off
- Bolt pattern meets ANSI/ASME B16.5 Class 150 standard
- Bi-directional: can be installed in either direction
- Gear box (Aluminum for sizes 2-6", Cast Iron for sizes 8-16") are painted for corrosion-resistance (non-submersible)
- Stainless Steel Hardware
- Face to face dimensions match ©Asahi Type 56/57 BFV for direct retro fit ©ASAHI/America, 35 Green St., Malden, MA 02148
- 3 Year Limited Warranty

- Wafer type stocked in PVC/EPDM. For PVC/FKM, PVC/Buna, CPVC/EPDM, CPVC/FKM, please check with Customer Service for lead-time..

- Lug type available in PVC/EPDM with 304SS Lug Inserts. Install between two flanges using a separate set of bolts & washers for each flange. This setup permits either side of the piping system to be disconnected without disturbing the other side.

- See Bottom of Next Page for Bolt Set Information

- Maximum operating pressure:**
- For Wafer Type & Lug Type BFV installed in-line at: 150 PSI* for 2 - 10", 100 PSI* for 12"
- For Lug Type BFV used in "Dead-End" or "End-of-line" Service (No downstream flanges and disc in closed position): 3"- 12" 75 PSI*

*non-shock water at 73° F

Note: For Lever type Butterfly Valves, see Colonial 311N, 411N, or 711N Series.



SAMPLE ENGINEERING SPECIFICATIONS

Butterfly valve body and disc shall be produced of PVC Type I, cell classification 12454 or CPVC Type IV, cell classification 23447 material. Valve boot/seal and O-rings shall be made of EPDM, FKM or Buna-N (NBR) material. Stem shall be made of stainless steel. The disc bore (center) shall contain a integrally molded stainless steel reinforcement square liner, which engages with the stainless steel valve stem. Boot/seal (liner) and disc shall be the only wetted parts of the valve. Gear operator shall include a position indicator. Bolt pattern shall conform to ANSI/ASME B 16.5 Class 150 standard. Maximum operating pressure for Wafer Type & Lug Type BFV installed in-line at ambient temperature is 150 PSI* for 2 - 10", 100 PSI* for 12". For Lug Type BFV used in "Dead-End" or "End-of-line" Service (No downstream flanges and disc in closed position): 3"- 12" 75 PSI*.



Lug Type

Revised 1/5/21 (Updated Bolt Set Information)

**TEMPERATURE DE-RATING
FOR VALVES & UNIONS
(ABOVE 73°)**

TEMP (°F)	PVC	CPVC	PP
73	1.00	1.00	1.00
80	0.88	0.96	0.93
90	0.75	0.92	0.83
100	0.62	0.85	0.74
110	0.50	0.77	0.66
120	0.40	0.70	0.58
130	0.30	0.62	0.51
140	0.22	0.55	0.40
150	NR	0.47	0.38
160	NR	0.40	0.35
170	NR	0.32	0.29
180	NR	0.25	0.23
200	NR	0.18	0.14
210	NR	0.15	0.10
240	NR	NR	NR
280	NR	NR	NR

NR: Not Recommended

Caution: Colonial recommends a minimum installation of 10 X the pipe diameter from a pump or other sources of turbulence.

**STEM EXTENSIONS & CHAIN WHEELS
ARE AVAILABLE**

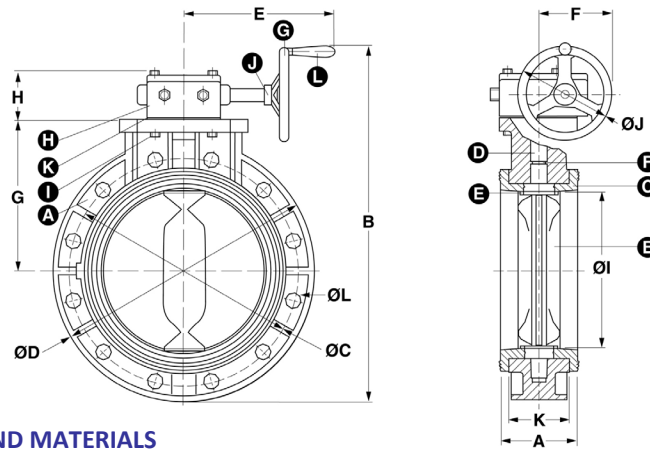
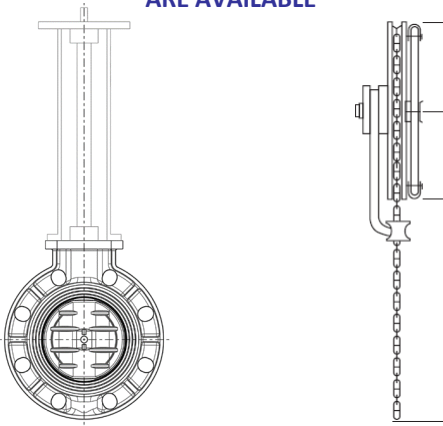

COMPONENTS AND MATERIALS

Part Letter	Component	Quantity	Material
A	Body	1	PVC, CPVC*1
B	Disc	1	PP, CPVC*1
C	Seal	1	EPDM, FKM, Buna-N
D	Stem	1	410 SS
E	O-Ring	2	EPDM, FKM, Buna-N
F	Stem O-Ring	2	EPDM, FKM, Buna-N
G	Handwheel	1	Cast Iron
H	Gear Box	1	Coated Metal*2
I	Bolt & Washer	4	304 SS
J	Spring Pin	1	Steel
K	Packing	1	EPDM, FKM, Buna-N
L	Small Handle	1	Steel

*1CPVC material choices are special order. Call for price and availability.

*2 2 - 6" Aluminum, 8 - 16" Cast Iron

SIZE & PART NUMBERS

TYPE	WAFER	WAFER	WAFER	WAFER	WAFER	LUG
SIZE	PVC/EPDM	PVC/BUNA	PVC/FKM	CPVC/EPDM	CPVC/FKM	PVC/EPDM w/SS LUG INSERTS
2	V20411NG	-	V20412NG	V20413NG	V20414NG	-
3	V30411NG	V30415NG	V30412NG	V30413NG	V30414NG	V30411NGL
4	V40411NG	V40415NG	V40412NG	V40413NG	V40414NG	V40411NGL
6	V60411NG	V60415NG	V60412NG	V60413NG	V60414NG	V60411NGL
8	V80411NG	V80415NG	V80412NG	V80413NG	V80414NG	V80411NGL
10	V100411NG	-	V100412NG	V100413NG	V100414NG	V100411NGL
12	V120411NG	-	V120412NG	V120413NG	V120414NG	V120411NGL
14	V140411NG	-	-	-	-	-
16	V160411NG	-	-	-	-	-

DIMENSIONS (Inches)

Size	A	B	ØC	ØD	E	F	n-Ø-e	G	H	ØI	ØJ	K	ØL	Wafer Type		Lug Type	
														wgt/lbs		wgt/lbs	
2	1.69	11.69	4.76	6.50	4.73	4.36	4 - .75	4.06	2.80	2.22	6.00	1.38	0.75	7.40	-	-	
3	1.81	12.85	5.98	7.87	4.73	4.36	4 - .75	4.53	2.80	3.13	6.00	1.42	0.75	8.30	11.30	-	
4	2.20	14.22	7.52	9.02	4.73	4.36	8 - .75	5.33	2.80	4.04	6.00	1.85	0.75	10.30	13.30	-	
6	2.78	16.96	9.49	11.22	4.73	4.36	8 - .87	6.97	2.80	6.02	6.00	2.44	0.87	17.20	20.20	-	
8	3.35	21.25	11.72	13.50	10.94	6.19	8 - .87	8.27	3.00	7.99	7.88	3.06	0.87	31.00	34.00	-	
10	4.29	23.88	14.25	16.19	10.94	6.19	12 - 1.00	9.44	3.00	10.03	7.88	3.75	1.00	41.00	51.00	-	
12	5.24	28.03	17.00	19.28	13.00	7.28	12 - 1.00	11.69	3.00	12.25	9.84	4.50	1.00	59.50	75.00	-	
14	5.00	28.86	18.74	20.87	13.00	7.28	12 - 1.14	11.81	3.07	13.98	9.92	4.45	1.14	101.00	-	-	
16	6.62	34.25	21.26	23.46	13.90	9.09	16 - 1.14	13.58	4.72	15.65	11.81	5.98	1.14	152.00	-	-	

Bolt Sets for Lug Type BFV 316SS

Size	3	4	6	8	10	12
Part Number	V30LBFKS	V40LBFKS	V60LBFKS	V80LBFKS	V100LBFKS	V120LBFKS
Thread	1/2 - 13	1/2 - 13	5/8 - 11	5/8 - 11	3/4 - 10	3/4 - 10
Bolt length	2.00	2.25	2.75	3.25	3.75	4.25
Qty of Bolts & Washers Per Set	8	16	16	16	24	24

Bolt Sets for Wafer Type BFV

Size	2-3	4	6	8	10	12
Part Number 304SS	V30BFGS	V40BFGS	V60BFGS	V80BFGS	V100BFGS	V120BFGS
Part Number Galv	V30BFGK	V40BFGK	V60BFGK	V80BFGK	V100BFGK	V120BFGK
Part Number Zinc	V30BFGZ	V40BFGZ	V60BFGZ	V80BFGZ	V100BFGZ	V120BFGZ
Thread	5/8 - 11	5/8 - 11	3/4 - 10	3/4 - 10	7/8 - 9	7/8 - 10
Bolt length	5.50	6	7	8	9	10
Qty of Bolts & Washers Per Set	4	8	8	8	12	12

DO NOT USE WITH COMPRESSED AIR OR GAS

CUSTOMER SERVICE: 6400 Corporate Ave., Portage, MI 49002

Toll-free (800)374 0234, Phone (269)323 2495, Fax (269) 323 0630 www.colonialengineering.com

Revised 1/5/21 (Updated Bolt Set Information)